

Saturday, 14 August 2021

Week 2 @ Willunga High School

Northern
Entrance

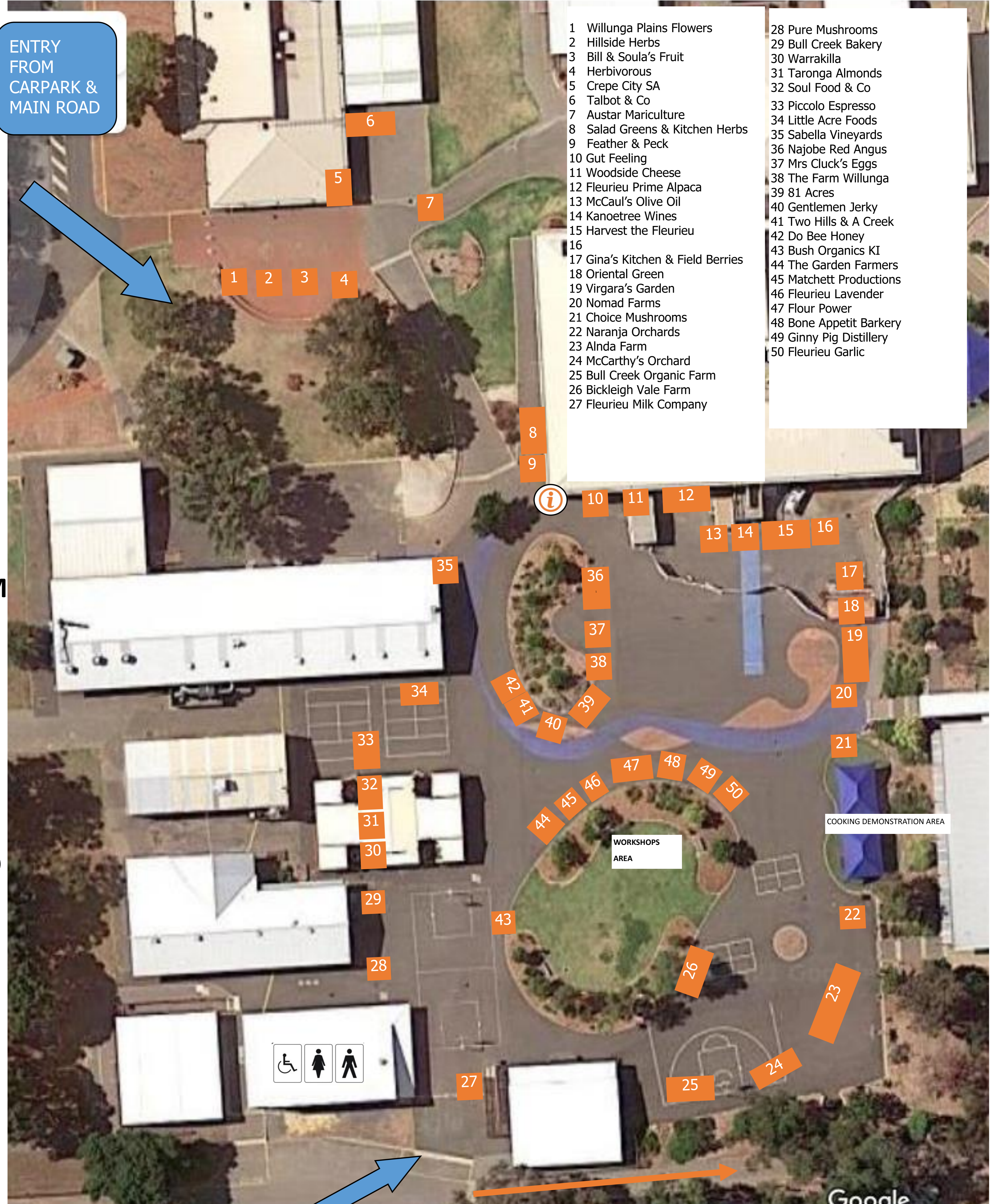

- 1 Willunga Plains Flowers
- 2 Hillside Herbs
- 3 Bill & Soula's Fruit
- 4 Herbivorous
- 5 Crepe City SA
- 6 Talbot & Co
- 7 Austar Mariculture
- 8 Salad Greens & Kitchen Herbs
- 9 Feather & Peck
- 10 Gut Feeling
- 11 Woodside Cheese
- 12 Fleurieu Prime Alpaca
- 13 McCaul's Olive Oil
- 14 Kanoetree Wines
- 15 Harvest the Fleurieu
- 16
- 17 Gina's Kitchen & Field Berries
- 18 Oriental Green
- 19 Virgara's Garden
- 20 Nomad Farms
- 21 Choice Mushrooms
- 22 Naranja Orchards
- 23 Alnda Farm
- 24 McCarthy's Orchard
- 25 Bull Creek Organic Farm
- 26 Bickleigh Vale Farm
- 27 Fleurieu Milk Company

- 28 Pure Mushrooms
- 29 Bull Creek Bakery
- 30 Warrakilla
- 31 Taronga Almonds
- 32 Soul Food & Co
- 33 Piccolo Espresso
- 34 Little Acre Foods
- 35 Sabella Vineyards
- 36 Najobe Red Angus
- 37 Mrs Cluck's Eggs
- 38 The Farm Willunga
- 39 81 Acres
- 40 Gentlemen Jerky
- 41 Two Hills & A Creek
- 42 Do Bee Honey
- 43 Bush Organics KI
- 44 The Garden Farmers
- 45 Matchett Productions
- 46 Fleurieu Lavender
- 47 Flour Power
- 48 Bone Appetit Barkery
- 49 Ginny Pig Distillery
- 50 Fleurieu Garlic

ENTRY FROM
CARPARK &
MAIN ROAD

ENTRY FROM
ACCESSIBLE
CARPARK &
MAIN ROAD

M
A
I
N
R
O
A
D



WORKSHOPS
AREA

COOKING DEMONSTRATION AREA

Google