

Saturday, 21 August 2021

Week 3 @ Willunga High School

Northern
Entrance

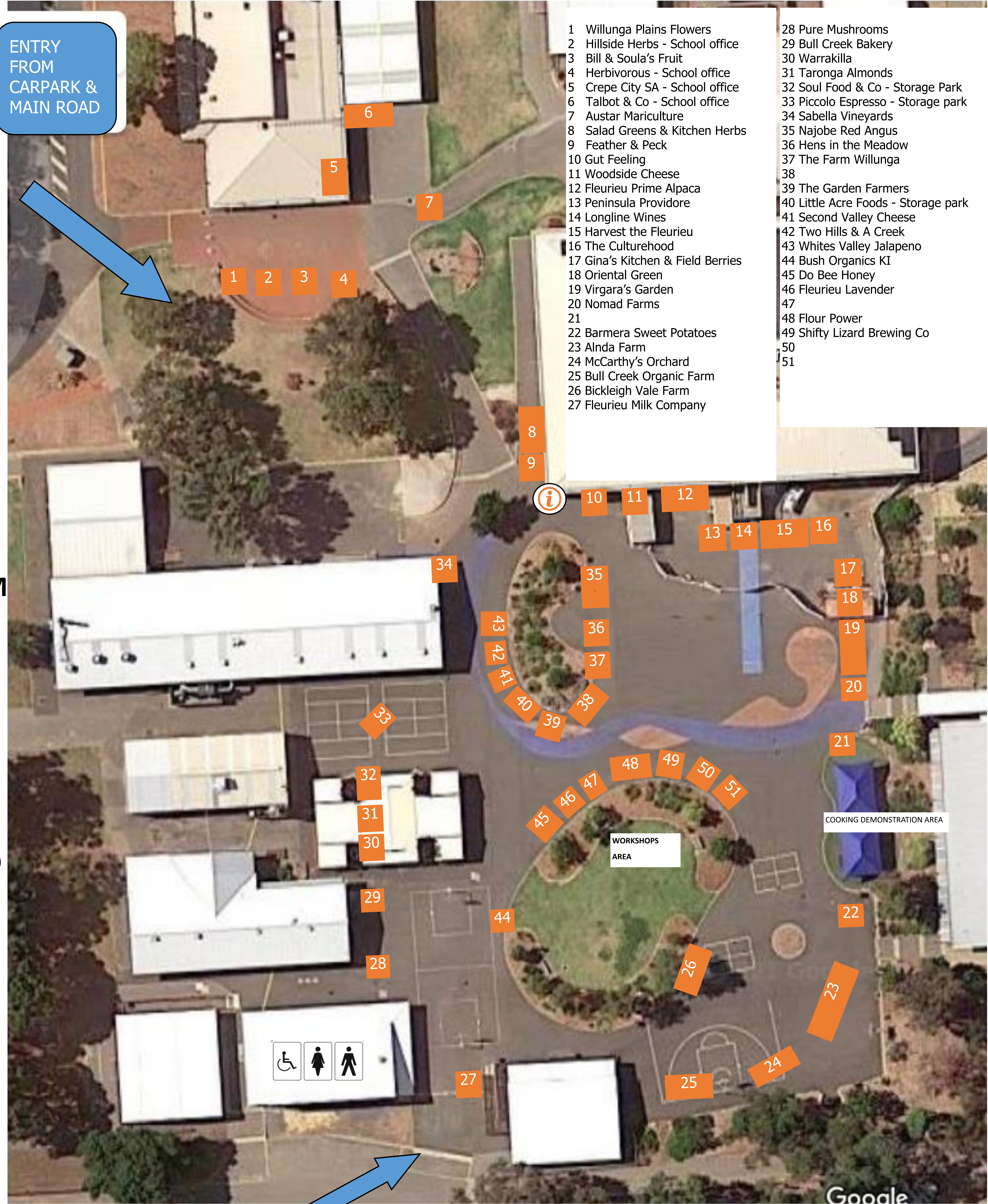

ENTRY FROM
CARPARK &
MAIN ROAD

- 1 Willunga Plains Flowers
- 2 Hillside Herbs - School office
- 3 Bill & Soula's Fruit
- 4 Herbivorous - School office
- 5 Crepe City SA - School office
- 6 Talbot & Co - School office
- 7 Austar Mariculture
- 8 Salad Greens & Kitchen Herbs
- 9 Feather & Peck
- 10 Gut Feeling
- 11 Woodside Cheese
- 12 Fleurieu Prime Alpaca
- 13 Peninsula Providore
- 14 Longline Wines
- 15 Harvest the Fleurieu
- 16 The Culturehood
- 17 Gina's Kitchen & Field Berries
- 18 Oriental Green
- 19 Virgara's Garden
- 20 Nomad Farms
- 21
- 22 Barmera Sweet Potatoes
- 23 Alnda Farm
- 24 McCarthy's Orchard
- 25 Bull Creek Organic Farm
- 26 Bickleigh Vale Farm
- 27 Fleurieu Milk Company
- 28 Pure Mushrooms
- 29 Bull Creek Bakery
- 30 Warrakilla
- 31 Taronga Almonds
- 32 Soul Food & Co - Storage Park
- 33 Piccolo Espresso - Storage park
- 34 Sabella Vineyards
- 35 Najobe Red Angus
- 36 Hens in the Meadow
- 37 The Farm Willunga
- 38
- 39 The Garden Farmers
- 40 Little Acre Foods - Storage park
- 41 Second Valley Cheese
- 42 Two Hills & A Creek
- 43 Whites Valley Jalapeno
- 44 Bush Organics KI
- 45 Do Bee Honey
- 46 Fleurieu Lavender
- 47
- 48 Flour Power
- 49 Shifty Lizard Brewing Co
- 50
- 51

M
A
I
N
R
O
A
D

ENTRY FROM
ACCESSIBLE
CARPARK &
MAIN ROAD

Southern
Entrance

Google