

Saturday, 28 August 2021

Week 4 @ Willunga High School

Northern Entrance

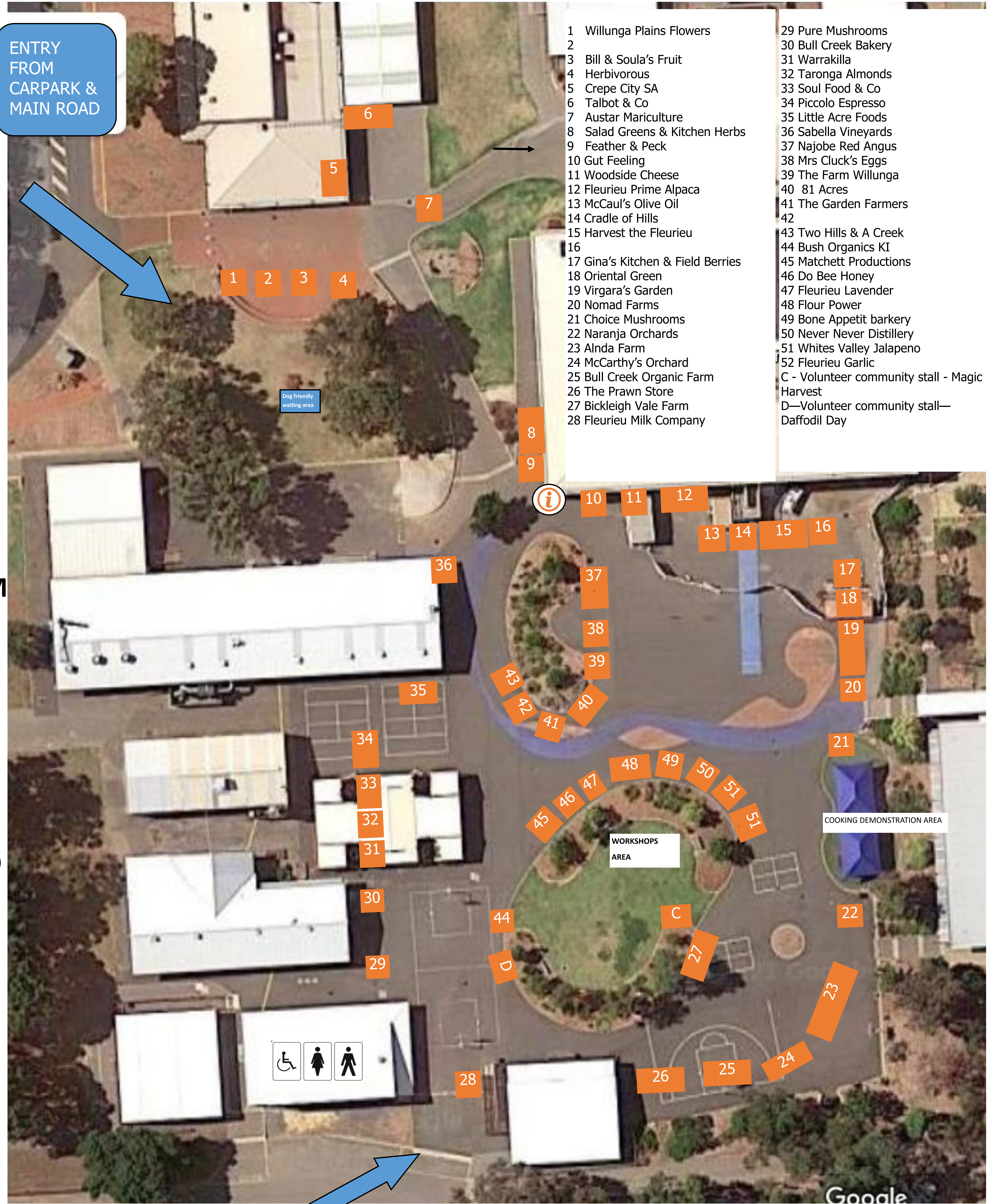

- | | |
|-----------------------------------|---|
| 1 Willunga Plains Flowers | 29 Pure Mushrooms |
| 2 | 30 Bull Creek Bakery |
| 3 Bill & Soula's Fruit | 31 Warrakilla |
| 4 Herbivorous | 32 Taronga Almonds |
| 5 Crepe City SA | 33 Soul Food & Co |
| 6 Talbot & Co | 34 Piccolo Espresso |
| 7 Austar Mariculture | 35 Little Acre Foods |
| 8 Salad Greens & Kitchen Herbs | 36 Sabella Vineyards |
| 9 Feather & Peck | 37 Najobe Red Angus |
| 10 Gut Feeling | 38 Mrs Cluck's Eggs |
| 11 Woodside Cheese | 39 The Farm Willunga |
| 12 Fleurieu Prime Alpaca | 40 81 Acres |
| 13 McCaul's Olive Oil | 41 The Garden Farmers |
| 14 Cradle of Hills | 42 |
| 15 Harvest the Fleurieu | 43 Two Hills & A Creek |
| 16 | 44 Bush Organics KI |
| 17 Gina's Kitchen & Field Berries | 45 Matchett Productions |
| 18 Oriental Green | 46 Do Bee Honey |
| 19 Virgara's Garden | 47 Fleurieu Lavender |
| 20 Nomad Farms | 48 Flour Power |
| 21 Choice Mushrooms | 49 Bone Appetit barkery |
| 22 Naranja Orchards | 50 Never Never Distillery |
| 23 Alnda Farm | 51 Whites Valley Jalapeno |
| 24 McCarthy's Orchard | 52 Fleurieu Garlic |
| 25 Bull Creek Organic Farm | C - Volunteer community stall - Magic Harvest |
| 26 The Prawn Store | D - Volunteer community stall - Daffodil Day |
| 27 Bickleigh Vale Farm | |
| 28 Fleurieu Milk Company | |

Southern Entrance

ENTRY FROM ACCESSIBLE CARPARK & MAIN ROAD

M
A
I
N
R
O
A
D

Google