

# Saturday, 11 September 2021

## Week 6 @ Willunga High School

Northern Entrance

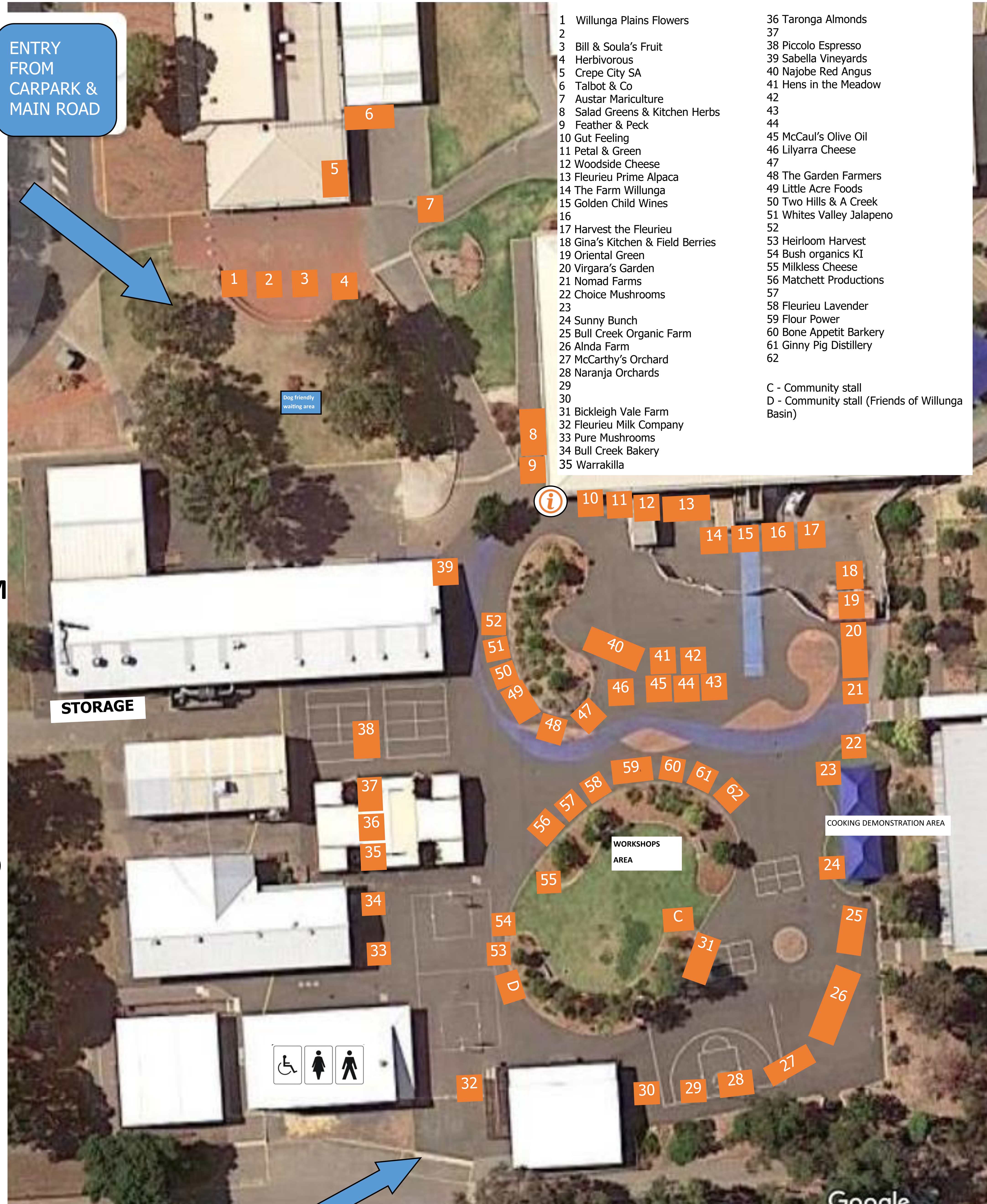

ENTRY FROM CARPARK & MAIN ROAD

- |                                   |                           |
|-----------------------------------|---------------------------|
| 1 Willunga Plains Flowers         | 36 Taronga Almonds        |
| 2                                 | 37                        |
| 3 Bill & Soula's Fruit            | 38 Piccolo Espresso       |
| 4 Herbivorous                     | 39 Sabella Vineyards      |
| 5 Crepe City SA                   | 40 Najobe Red Angus       |
| 6 Talbot & Co                     | 41 Hens in the Meadow     |
| 7 Astar Mariculture               | 42                        |
| 8 Salad Greens & Kitchen Herbs    | 43                        |
| 9 Feather & Peck                  | 44                        |
| 10 Gut Feeling                    | 45 McCaul's Olive Oil     |
| 11 Petal & Green                  | 46 Lilyarra Cheese        |
| 12 Woodside Cheese                | 47                        |
| 13 Fleurieu Prime Alpaca          | 48 The Garden Farmers     |
| 14 The Farm Willunga              | 49 Little Acre Foods      |
| 15 Golden Child Wines             | 50 Two Hills & A Creek    |
| 16                                | 51 Whites Valley Jalapeno |
| 17 Harvest the Fleurieu           | 52                        |
| 18 Gina's Kitchen & Field Berries | 53 Heirloom Harvest       |
| 19 Oriental Green                 | 54 Bush organics KI       |
| 20 Virgara's Garden               | 55 Milkless Cheese        |
| 21 Nomad Farms                    | 56 Matchett Productions   |
| 22 Choice Mushrooms               | 57                        |
| 23                                | 58 Fleurieu Lavender      |
| 24 Sunny Bunch                    | 59 Flour Power            |
| 25 Bull Creek Organic Farm        | 60 Bone Appetit Barkery   |
| 26 Alnda Farm                     | 61 Ginny Pig Distillery   |
| 27 McCarthy's Orchard             | 62                        |
| 28 Naranja Orchards               |                           |
| 29                                |                           |
| 30                                |                           |
| 31 Bickleigh Vale Farm            |                           |
| 32 Fleurieu Milk Company          |                           |
| 33 Pure Mushrooms                 |                           |
| 34 Bull Creek Bakery              |                           |
| 35 Warrakilla                     |                           |

C - Community stall  
D - Community stall (Friends of Willunga Basin)

M  
A  
I  
N  
R  
O  
A  
D

STORAGE

Dog friendly waiting area



WORKSHOPS AREA

COOKING DEMONSTRATION AREA



Southern Entrance

ENTRY FROM ACCESSIBLE CARPARK & MAIN ROAD

Google