

Saturday, 25 September 2021

Week 8 @ Willunga High School

Northern Entrance

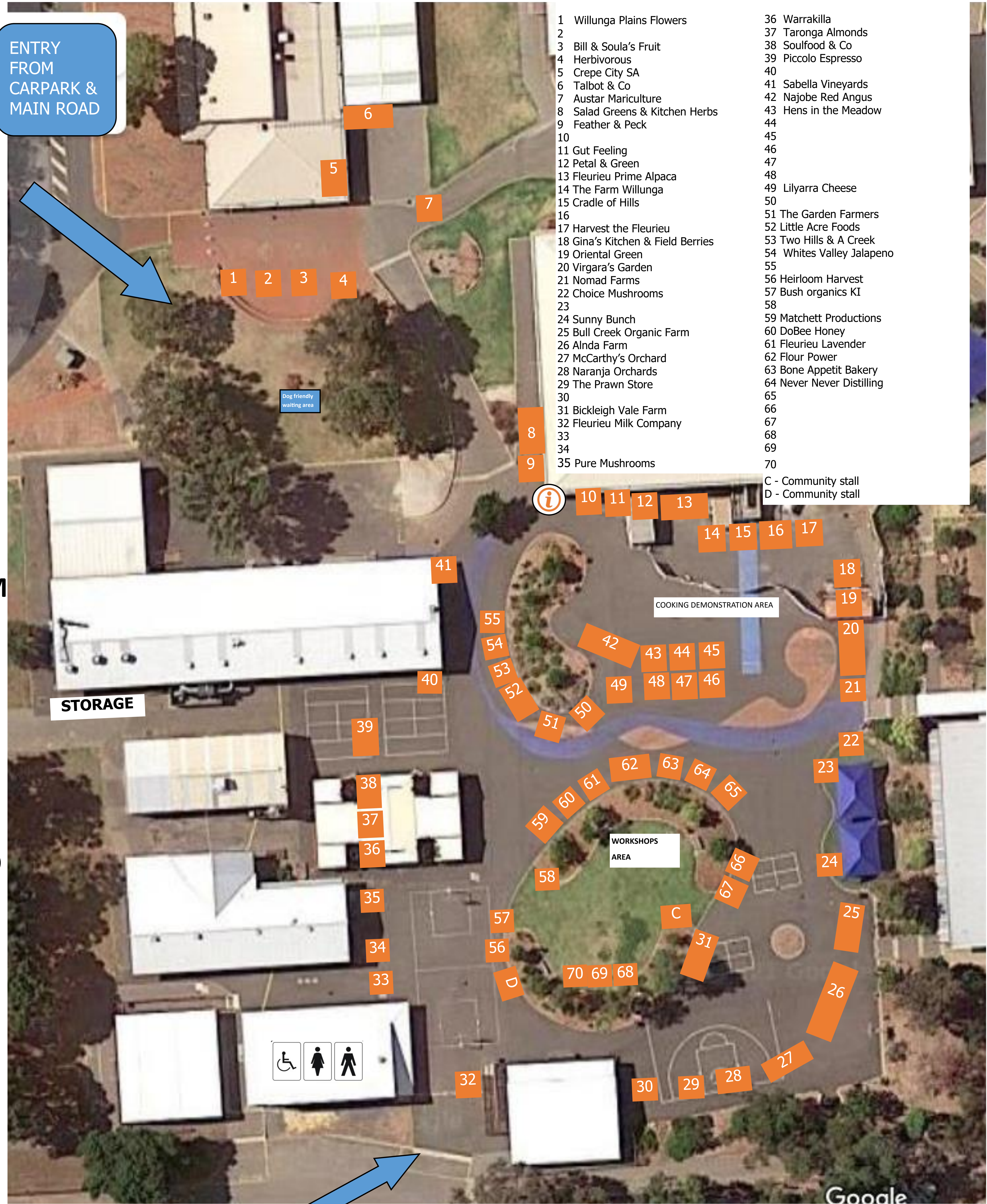

ENTRY FROM CARPARK & MAIN ROAD

- | | |
|-----------------------------------|---------------------------|
| 1 Willunga Plains Flowers | 36 Warrakilla |
| 2 | 37 Taronga Almonds |
| 3 Bill & Soula's Fruit | 38 Soulfood & Co |
| 4 Herbivorous | 39 Piccolo Espresso |
| 5 Crepe City SA | 40 |
| 6 Talbot & Co | 41 Sabella Vineyards |
| 7 Austar Mariculture | 42 Najobe Red Angus |
| 8 Salad Greens & Kitchen Herbs | 43 Hens in the Meadow |
| 9 Feather & Peck | 44 |
| 10 | 45 |
| 11 Gut Feeling | 46 |
| 12 Petal & Green | 47 |
| 13 Fleurieu Prime Alpaca | 48 |
| 14 The Farm Willunga | 49 Lilyarra Cheese |
| 15 Cradle of Hills | 50 |
| 16 | 51 The Garden Farmers |
| 17 Harvest the Fleurieu | 52 Little Acre Foods |
| 18 Gina's Kitchen & Field Berries | 53 Two Hills & A Creek |
| 19 Oriental Green | 54 Whites Valley Jalapeno |
| 20 Virgara's Garden | 55 |
| 21 Nomad Farms | 56 Heirloom Harvest |
| 22 Choice Mushrooms | 57 Bush organics KI |
| 23 | 58 |
| 24 Sunny Bunch | 59 Matchett Productions |
| 25 Bull Creek Organic Farm | 60 DoBee Honey |
| 26 Alnda Farm | 61 Fleurieu Lavender |
| 27 McCarthy's Orchard | 62 Flour Power |
| 28 Naranja Orchards | 63 Bone Appetit Bakery |
| 29 The Prawn Store | 64 Never Never Distilling |
| 30 | 65 |
| 31 Bickleigh Vale Farm | 66 |
| 32 Fleurieu Milk Company | 67 |
| 33 | 68 |
| 34 | 69 |
| 35 Pure Mushrooms | 70 |
- C - Community stall
D - Community stall

M
A
I
N
R
O
A
D

ENTRY FROM ACCESSIBLE CARPARK & MAIN ROAD

Southern Entrance